

AK/AK-B Series

□24mm/□42mm/□60mm/□85mm Shaft Type
 □42mm/□60mm/□85mm Shaft Type+Brake Built-In Type

■ Features

- Compact design and light weight with high accuracy, speed and torque
- Suitable for small-sized equipment applications
- Brake built-in □42mm, □60mm, □85mm of shaft type for compact equipment (AK-B Series)
- Brake force is released (AK-B Series) when applying power on brake wire
- Cost-effective

⚠ Please read "Caution for your safety" in operation manual before using.

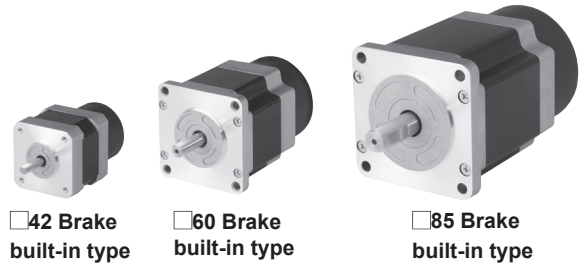
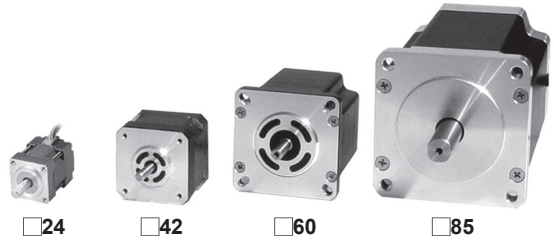

■ Dimensions

- ※These dimensions are for dual shaft models. Single shaft models do not include shafts indicated in the dotted lines.
- ※For flexible coupling (ERB Series) information, refer to the catalogue. (□24, □48, □60(Standard shaft type))
- ※Brake is non-polar and be sure to observe rated excitation voltage (24VDC). (Except for □24)
 SW1 ON : Brake Release / SW1 OFF : Brake Execute

◎ □24

(unit: mm)

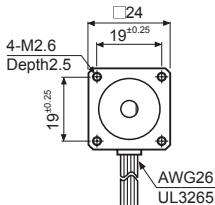

Sectioned A-A'

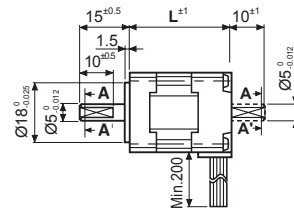

Model	L
02K-S523 (W)	30.5
04K-S525 (W)	46.5

(unit: mm)

◎ □42

(unit: mm)

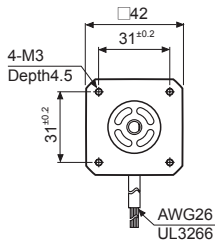

Sectioned A-A'

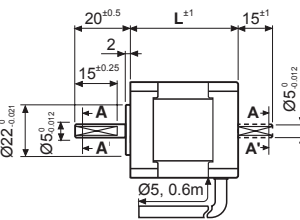

<Standard type>

Model	L
A1K-S543 (W)-B	33
A2K-□544 (W)-B	39
A3K-S545 (W)-B	47

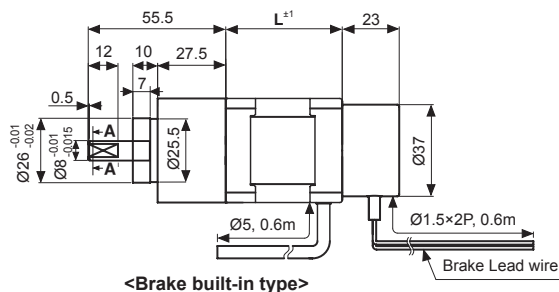
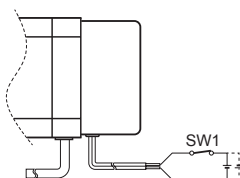

<Brake built-in type>

5-Phase Stepper Motor

Dimensions

⊙ □ 60

(unit: mm)

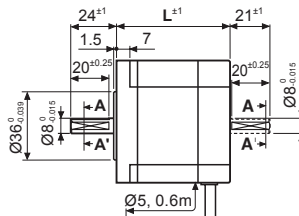
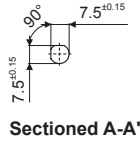
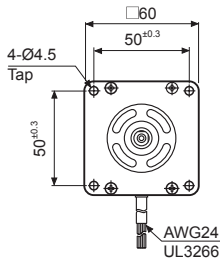

<Standard type>

Model	L
A4K-□564 (W)-□B	48.5
A8K-□566 (W)-□B	59.5
A16K-□569 (W)-□B	89

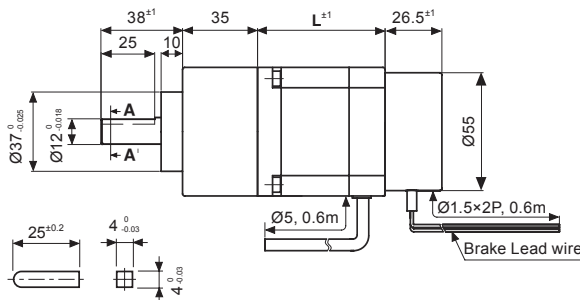
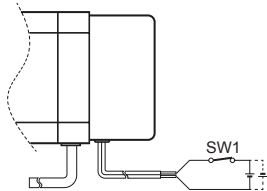

<Brake built-in type>

⊙ □ 85

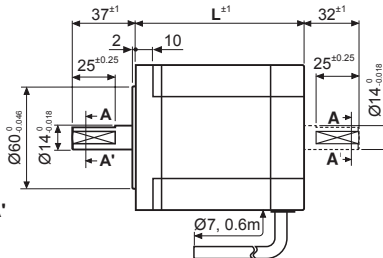
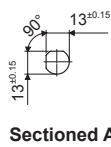
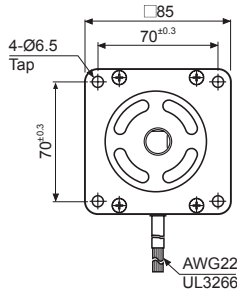

<Standard type>

Model	L
A21K-□596 (W)-□B	68
A41K-□599 (W)-□B	98
A63K-□5913 (W)-□B	128

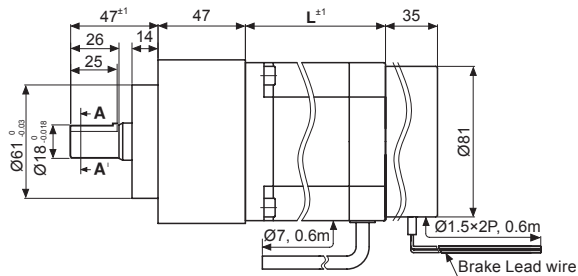
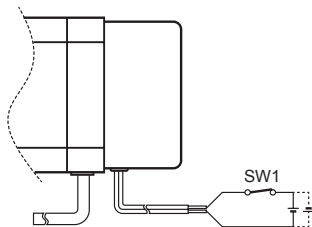

<Brake built-in type>

- (A) Photoelectric Sensors
- (B) Fiber Optic Sensors
- (C) Door/Area Sensors
- (D) Proximity Sensors
- (E) Pressure Sensors
- (F) Rotary Encoders
- (G) Connectors/ Sockets
- (H) Temperature Controllers
- (I) SSRs / Power Controllers
- (J) Counters
- (K) Timers
- (L) Panel Meters
- (M) Tacho / Speed / Pulse Meters
- (N) Display Units
- (O) Sensor Controllers
- (P) Switching Mode Power Supplies
- (Q) Stepper Motors & Drivers & Controllers
- (R) Graphic/ Logic Panels
- (S) Field Network Devices
- (T) Software

AK/AK-B Series

Characteristic

● 02K-S523

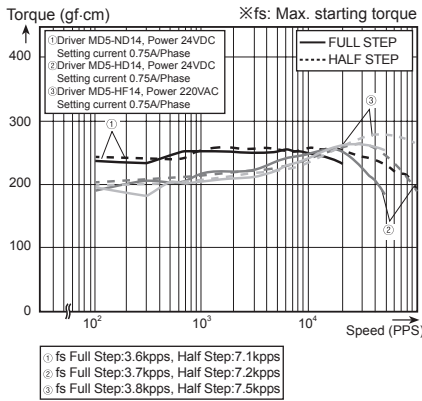

● 04K-S525

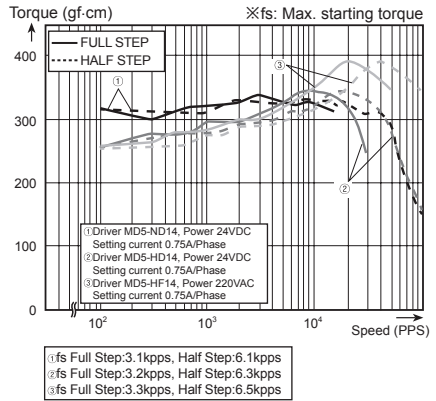

● A1K-S543/A1K-S543-B

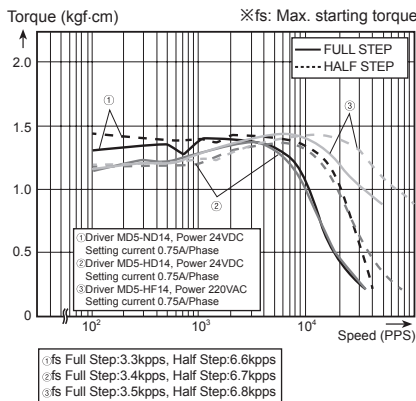

● A2K-□544/A2K-□544-B

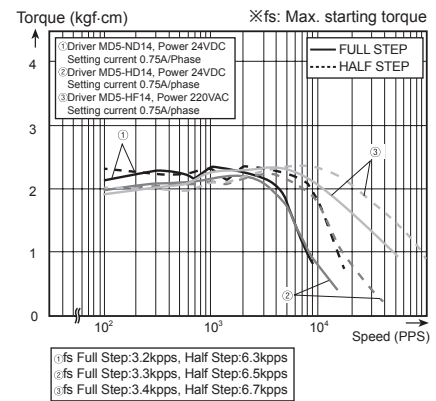

● A3K-S545/A3K-S545-B

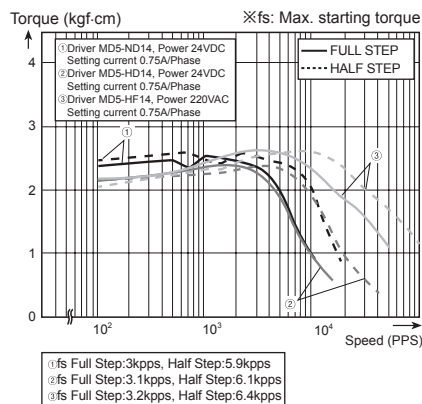

● A4K-□564 / A4K-M564-B

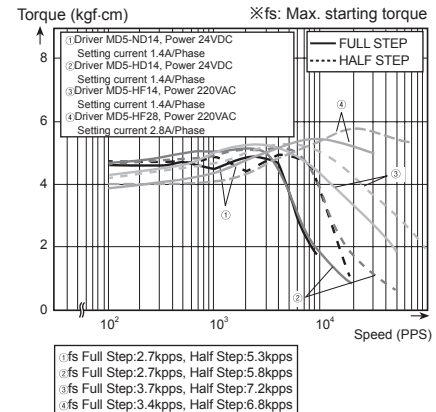

5-Phase Stepper Motor

Characteristic

● A8K-□566 / A8K-M566-B

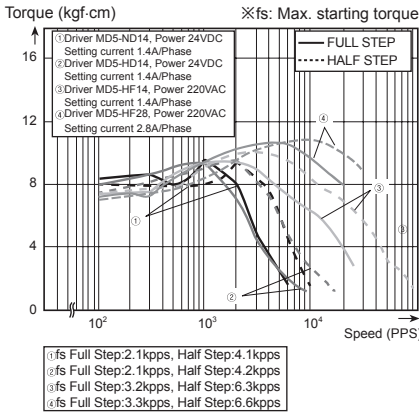

● A16K-□569 / A16K-□569-B

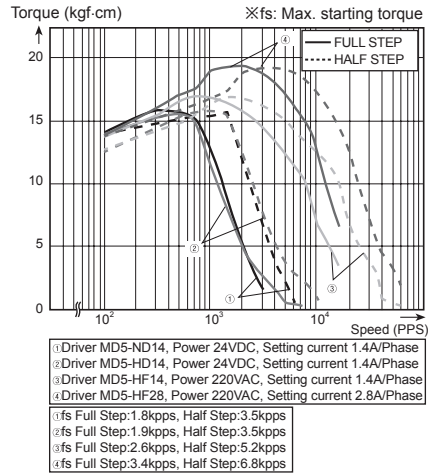

● A21K-□596 / A21K-□596-B

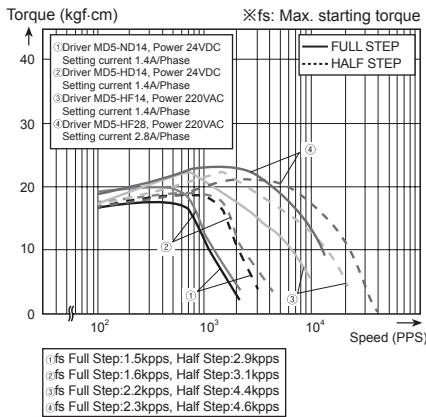

● A41K-□599 / A41K-□599-B

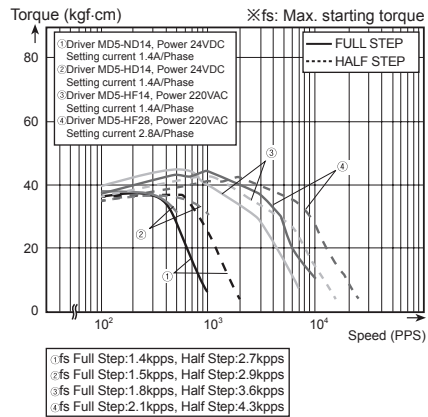

● A63K-□5913 / A63K-□5913-B

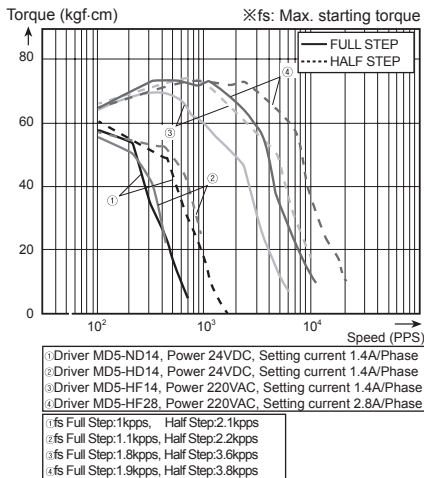

(A)	Photoelectric Sensors
(B)	Fiber Optic Sensors
(C)	Door/Area Sensors
(D)	Proximity Sensors
(E)	Pressure Sensors
(F)	Rotary Encoders
(G)	Connectors/ Sockets
(H)	Temperature Controllers
(I)	SSRs / Power Controllers
(J)	Counters
(K)	Timers
(L)	Panel Meters
(M)	Tacho / Speed / Pulse Meters
(N)	Display Units
(O)	Sensor Controllers
(P)	Switching Mode Power Supplies
(Q)	Stepper Motors & Drivers & Controllers
(R)	Graphic/ Logic Panels
(S)	Field Network Devices
(T)	Software